



Department of  
Environmental  
Conservation

# HAMMOND POND WILD FOREST

---

## Draft Amendment

to the

**1988 Hammond Pond Wild Forest Unit Management Plan**

**NYS DEC, REGION 5, DIVISION OF LANDS AND FORESTS**

232 Golf Course Road, Warrensburg, NY 12885  
r5.ump@dec.ny.gov

This page intentionally left blank

## **INTRODUCTION**

The Hammond Pond Wild Forest Area (HPWF) is comprised of approximately 45,558 acres in the Towns of Keene, Elizabethtown, Westport, North Hudson, Moriah, Crown Point, Schroom, and Ticonderoga in Essex County. A Unit Management Plan (UMP) was completed for the unit in 1988. A 1993 "Generic Bicycle Amendment for Completed Adirondack Forest Preserve Unit Management Plans" proposed an Amendment to the HPWF (and several other Forest Preserve units) to allow bicycle use on certain trails. This is the first formal Amendment to the 1988 HPWF UMP.

This is a project-specific amendment that proposes the construction of an accessible hard packed gravel walkway and viewing area at the Route 73/Route 9N intersection in the Town of Keene. These facilities are additional to improvements to the existing parking area, which is located both inside and outside of the right-of-way (ROW) on the southbound side of Route 73. Parking area improvements were previously determined by APA to be jurisdictional and are subject to APA project order #P2006-294.

## **PROPOSED MANAGEMENT ACTIONS**

### Background:

Over time, the existing parking area has expanded outside the Route 73 ROW and onto the Forest Preserve. To reclaim this encroachment, a paved pull-off with 8 parking spaces will be created, and delineated with boulders to restrict future expansion. The remaining filled area will be reclaimed, and allowed to return to a natural state. These improvements to the parking area are located both within and outside the Route 73 ROW. Final plans for these improvements are attached.

### Facilities Development:

A 5' wide hard surfaced walkway, built to ADA standards, will extend from the northern end of the paved parking area a short distance to a 20' diameter hard surfaced viewing area. The end of the hard surfaced walkway and the viewing area will be located outside the Route 73 and Route 9N ROW. The walkway and viewing area have been designed with highway safety standards in mind. Boulders will be installed around the outside of the viewing area. A railing may be installed along the gravel walkway and any such railing will be constructed of natural materials. A portion of the parking area and the walkway will be located on Hammond Pond Wild Forest (Figure 1).

Picnic tables and benches will be installed at this site, either near the viewing area or just outside the parking area boulders.

## PHOTOS



Photo 1: Looking west from proposed viewing area.



Photo 2: Existing conditions, as seen from proposed viewing area.



Photo 3: Paved pathway drawing, as seen from the proposed viewing area.

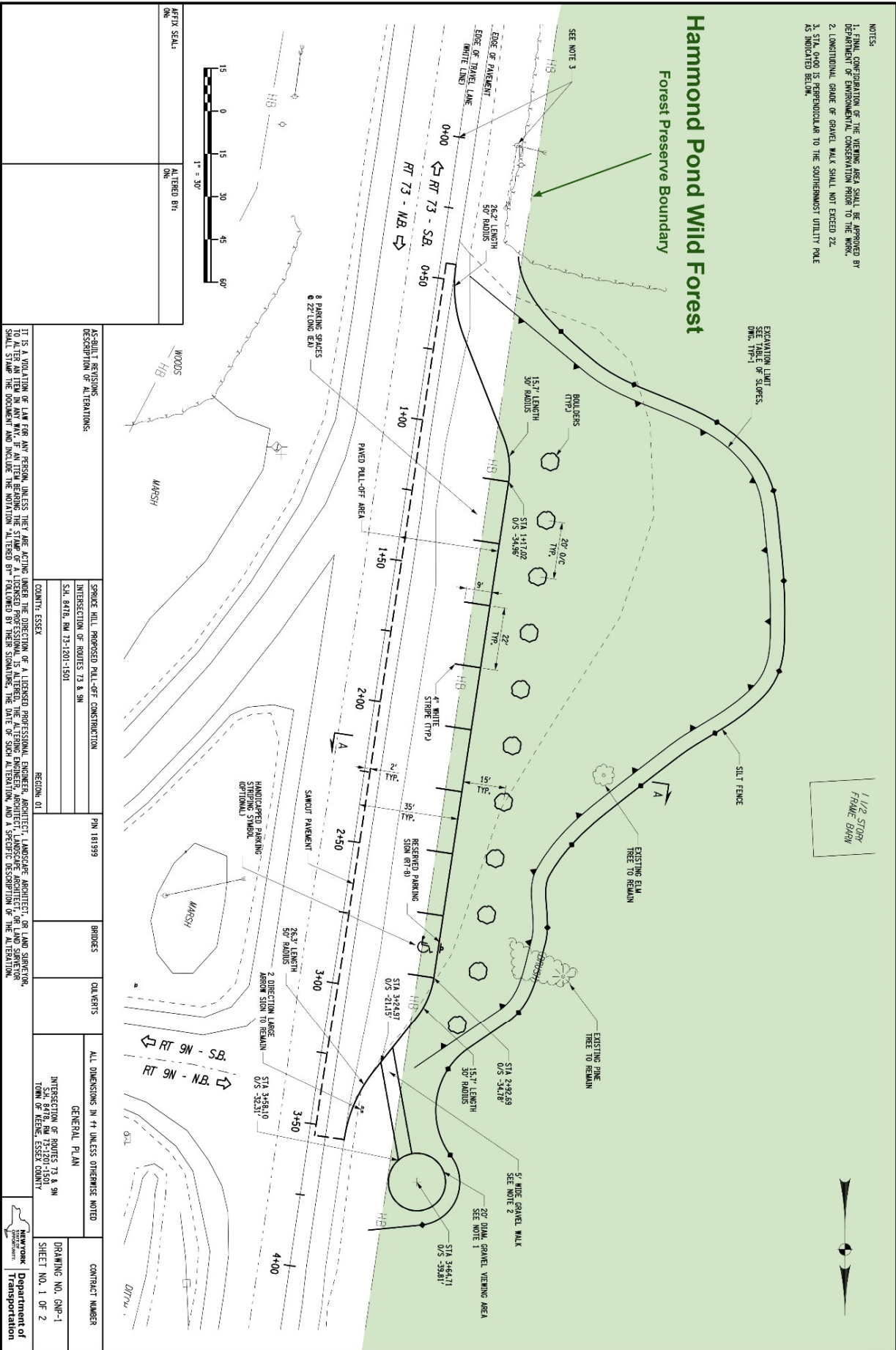

Figure 1: Features Located on Hammond Pond Wild Forest